

Formulate



features & benefits

Add a whole new dimension to your exhibit or display with a seamless graphic backwall. Formulate combines an easy to assemble aluminum tube framework with state-of-the-art high quality tension fabric graphic imagery. Both the horizontal and vertical curved systems come complete with a molded transit case and a selection of options and upgrades including a full range of lighting.

Formulate 1 Vertically curved FMLT-1

Formulate 2 Horizontally curved FMLT-2

hardware specifications	graphic specifications	additional info
Size: 10 ft	Formulate 1 Width: 114" (approximate) Height: 94.5" (approximate) Formulate 2 Width: 123.125" (approximate) Height: 92" (approximate)	Weight: 41 lbs.

We are continually improving and modifying our product range and reserve the right to vary the specifications without prior notice. All dimensions and weights quoted are approximate and we accept no responsibility for variance. E&OE.

Assembly Instructions

Step 1. Unpack small items from case then pull out large tube bag. Ground cloth should be used to keep frame & fabric clean.

Step 2. Assemble frame in numerical order as shown on right. Numbers will be on the back side of the tube. It is best to assemble with the frame laying flat as shown and set upright after the fabric is attached.

Step 3. Stretch fabric over frame.

- When working with fabric use gloves or clean hands and keep fabric away from dirty surfaces.
- Pull fabric over frame and secure with zipper.
- Add legs to back of unit.

Step 4. Stand unit upright.

- Adjust leveling feet on back of legs if needed.

Step 1. Unpack small items from case then pull out large tube bag. Ground cloth should be used to keep frame & fabric clean.

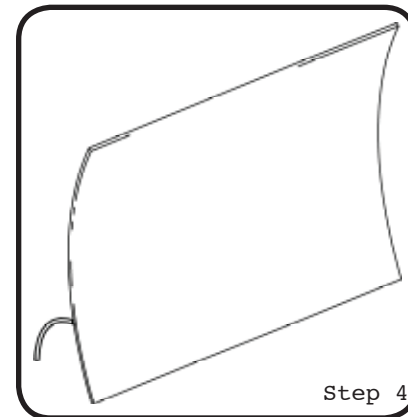
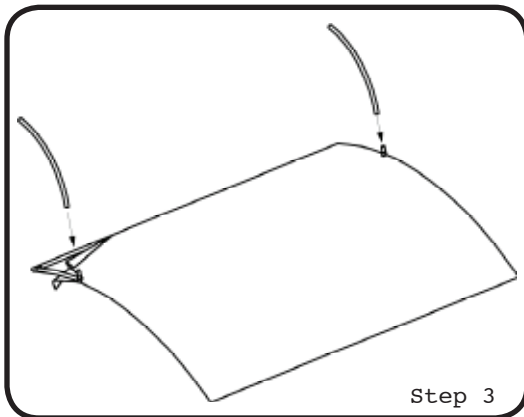
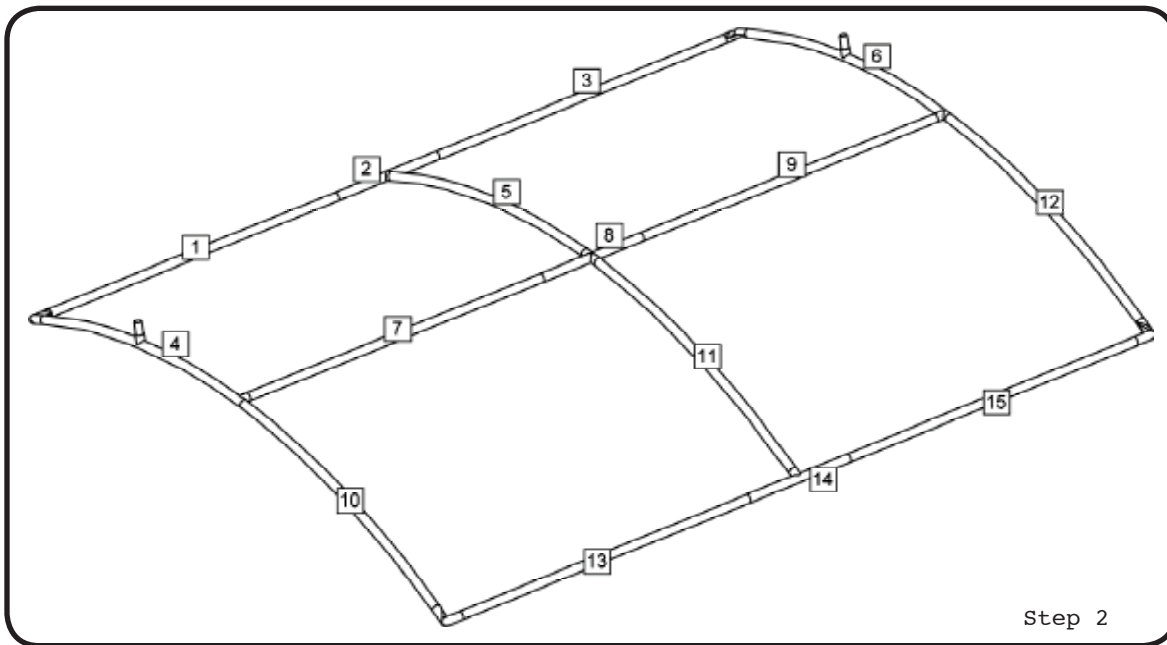

Assembly Instructions

FLMT-2

Step 1. Unpack small items from case then pull out large tube bag. Ground cloth should be used to keep frame & fabric clean.

Step 2. Assemble frame in numerical order as shown on right. Numbers will be on the back side of the tube. It is best to assemble with the frame laying flat as shown and set upright after the fabric is attached.

Step 3. Stretch fabric over frame.

- When working with fabric use gloves or clean hands and keep fabric away from dirty surfaces.
- Pull fabric over frame and secure with zipper.
- Add legs to back of unit.

Step 4. Stand unit upright.

- Adjust leveling feet on back of legs if needed.

Step 1. Unpack small items from case then pull out large tube bag. Ground cloth should be used to keep frame & fabric clean.

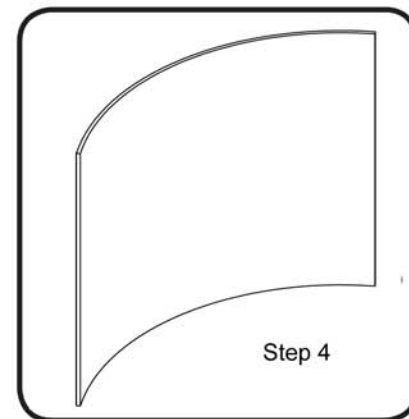
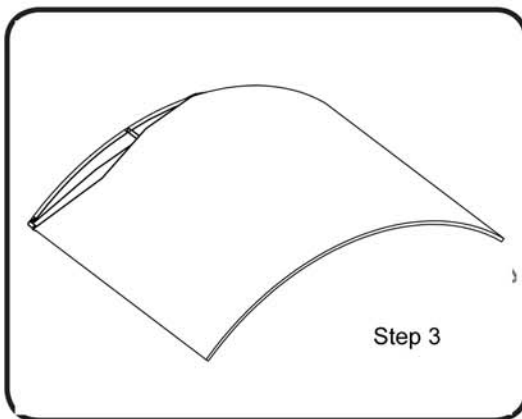
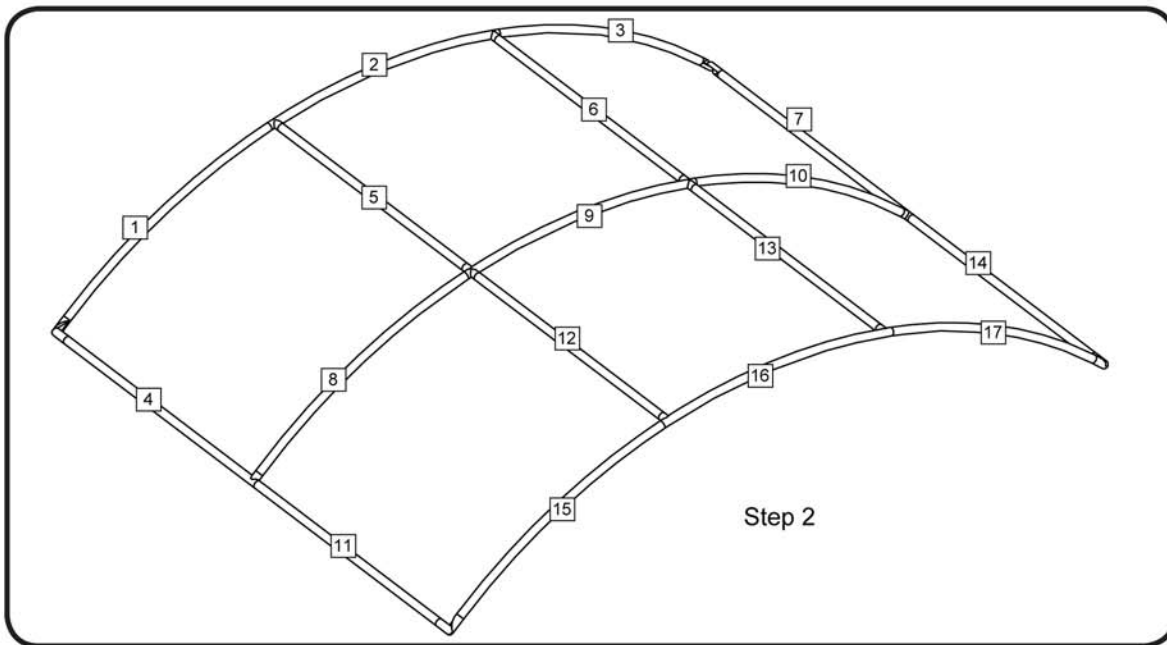

Assembly Instructions

FMLT-1-G shown w/optional FMLT-LP and FMLT-TT-(W,S)

Packing Accessories should be installed after fabric structure is assembled and fabric is put on frame. If using header, install header first.

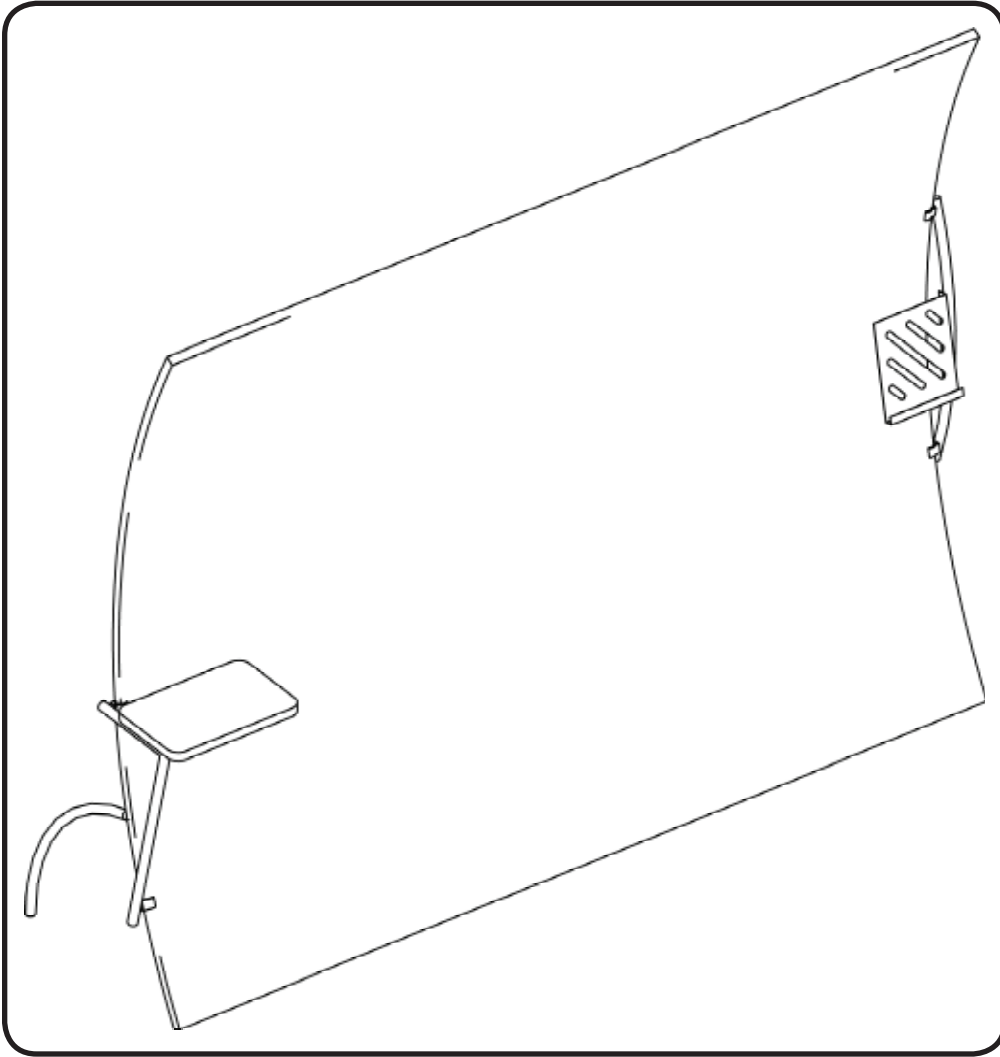

Side counter supports should be attached to side of main frame so that top of support is 39" from ground. Then attach counter top to support with thumb screws.

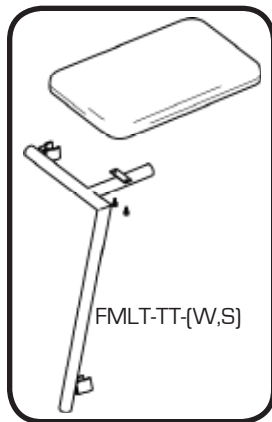

FMLT-TT-(W,S)

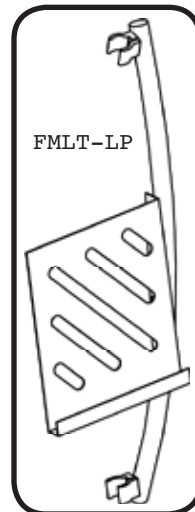

FMLT-LP

Clamp side mount literature holder to side of main structure.

Packing

All tubes except side mount counter supports should be put into the tube bag.

Pack tube bag first and unpack last.

Fabric should be folded and put into smaller zippered bag.

Accessories should be packed in middle of case.

Pack fabric bag last and unpack first.

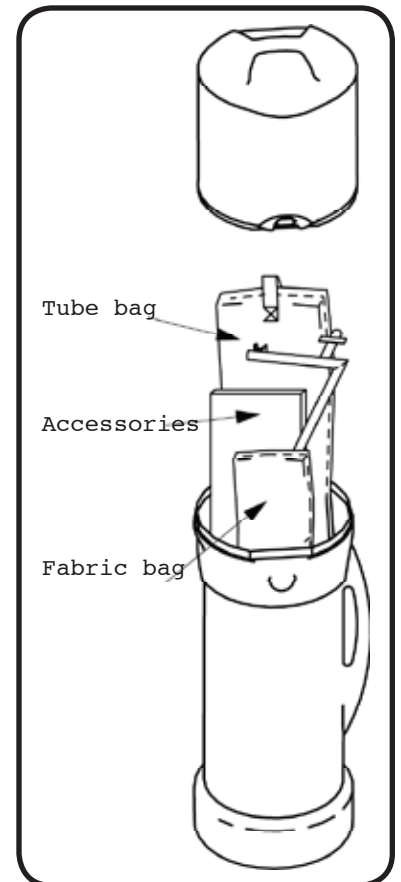

Tube bag

Accessories

Fabric bag

Assembly Instructions

FMLT-1

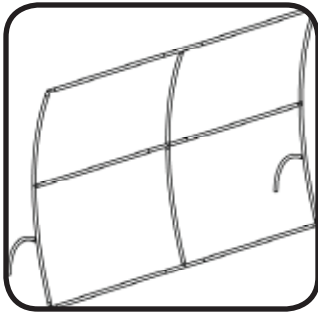

Wave Vertical Curve frame constructed of 30mm tube. Frame assembles with snap buttons. This is the base frame for all FMLT-1 kits on this page.

Kit# FMLT-1-G

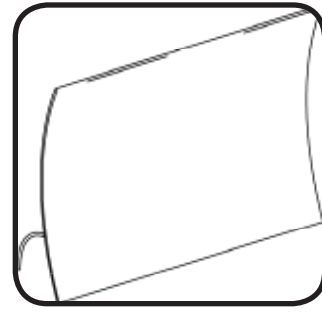

Kit includes: FMLT-1 frame, zippered pillowcase with graphic one side & OCL case Graphic Size: 114" x 94.5" Vertical This is the graphic size for the pillowcase cover for all FMLT-1 kits on this page.

Dimensions: 114" wide x 92" high Weight: 41 lbs.

FMLT-2

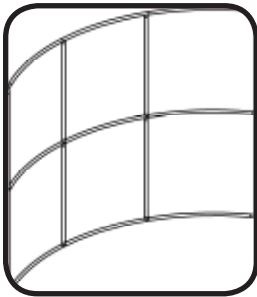

Wave Horizontal Curve frame constructed of 30mm tube. Frame assembles with snap buttons. This is the base frame for all FMLT-2 kits on this page.

Kit# FMLT-2-G

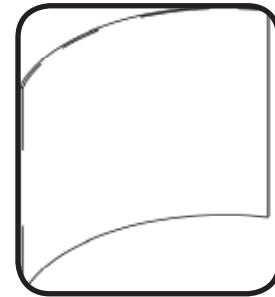

Kit includes: FMLT-2 frame, zippered pillowcase with graphic one side & OCL case Graphic Size: 123.125" x 92" Vertical This is the graphic size for the pillowcase cover for all FMLT-2 kits on this page.

Dimensions: 112" wide x 92" high Weight: 41 lbs.

Literature holders
FMLT-LP

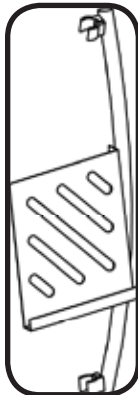

Side mount literature holders constructed of a curved 30mm brushed tube, 2 clamps & silver powder coated literature holder.

*Side mount literature holders may be used on all Formulate frames.

Dimensions: 11 7/16" wide x 36" high Weight: 3 lbs

Side counters
FMLT-TT-W (Wood)
FMLT-TT-S (Silver)

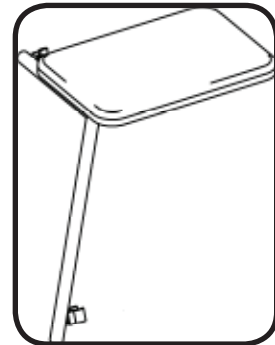

Side mount counter supports are constructed of 30mm brushed tube, 2 clamps and counter top bracket.

Wood finish: FMLT-TT-W 12" x 18" thermoformed counter top w/ 1 1/2" radius corners.

Silver finish: FMLT-TT-S 12" x 18" thermoformed counter top w/ 1 1/2" radius corners

*Side counters for use with Vertical curve frame only.

Dimensions: 18" wide x 28 1/2" high Weight: 7 lbs.